



Spare Parts and Options





Spare Parts and Options

For any order or price inquiry
please send your request to spareparts@jpm-group.com
and indicate the serial number of tipper or dropside.

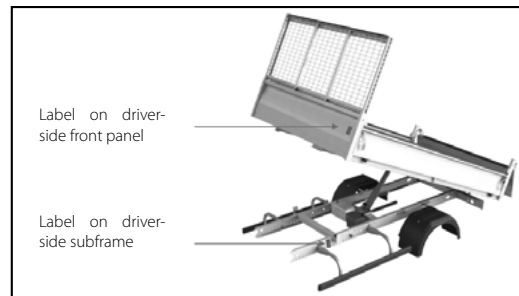
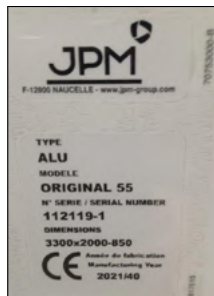

Label on driver-
side front panel

Label on driver-
side subframe

Rear Tipper

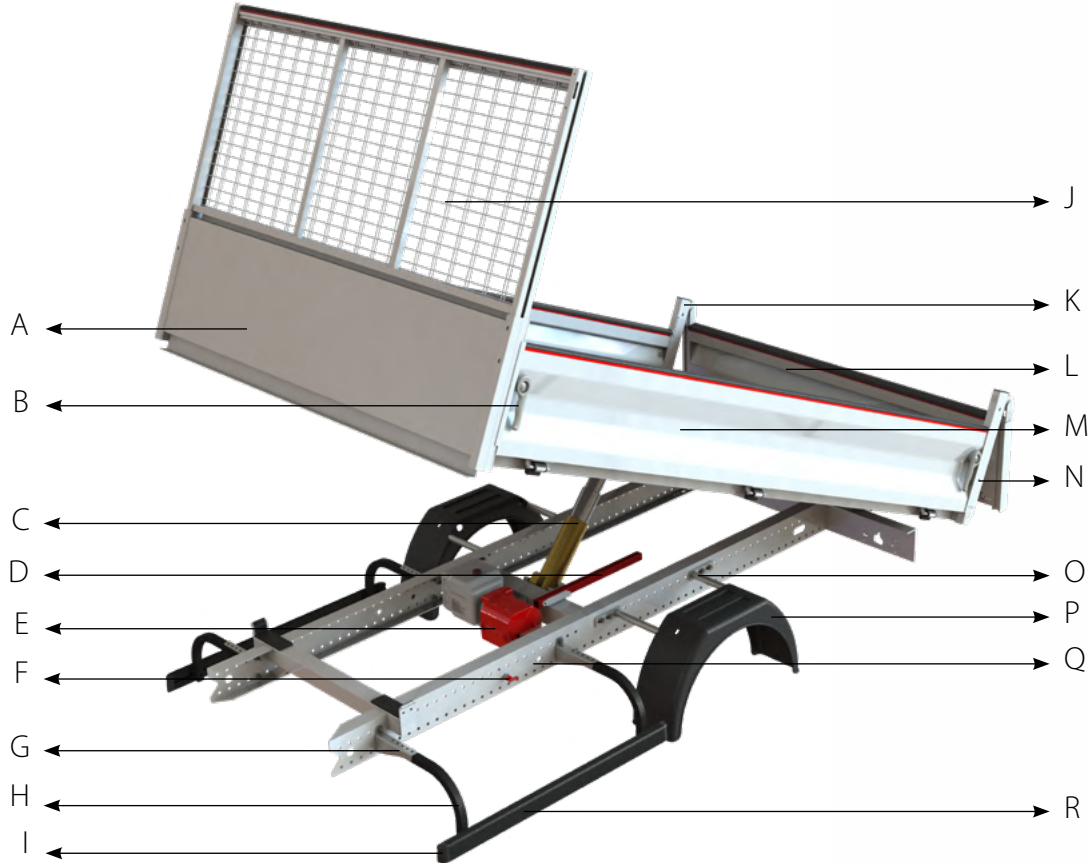

ITEM	DESIGNATION
A	Front wall
B	Locking grip
C	Telescopic cylinder
D	Safety strut
E	Electro pump unit
F	Circuit breaker
G	Fixation for elbow tube
H	Elbow tube for underrun protection
I	End cap for underrun protection
J	Gantry
K	Right rear pillar
L	Rear door
M	Sideboard
N	Left rear pillar
O	Mudguard bracket
P	Mudguard
Q	Subframe
R	JPM side underrun protection

3-Way Tipper

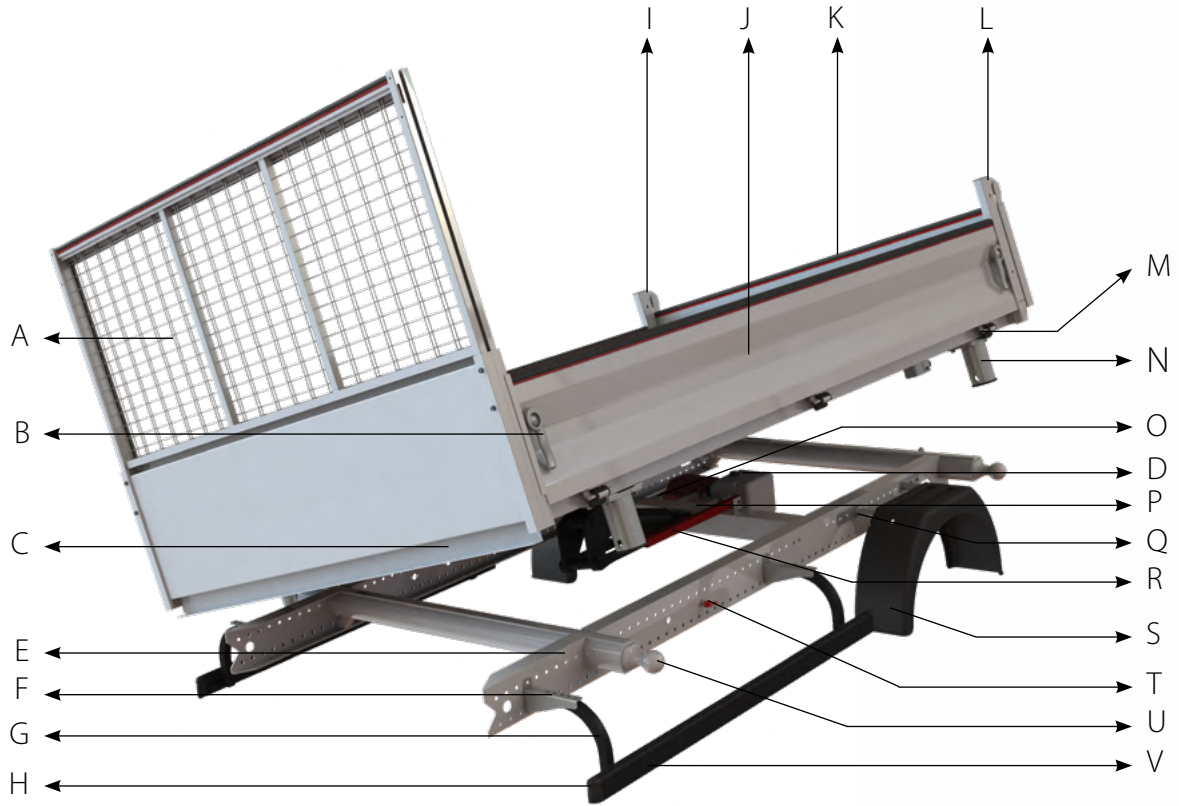

ITEM	DESIGNATION
A	Gantry
B	Locking grip
C	Loading platform
D	Electro pump unit
E	Subframe
F	Fixation for elbow tube
G	Elbow tube for underrun protection
H	End cap for underrun protection
I	Right rear pillar
J	Sideboard
K	Rear door
L	Left rear pillar
M	Ball bearing
N	Locking pin of three-way tipper hinge
O	Tipping hoist
P	Circuit breaker lateral tilting
Q	Mudguard bracket
R	Safety strut
S	Mudguard
T	Circuit breaker
U	Sphere
V	JPM side underrun protection

Dropside



ITEM	DESIGNATION
A	Gantry
B	Loading platform
C	End cap for underrun protection
D	JPM side underrun protection
E	Elbow tube for underrun protection
F	Mudguard bracket
G	Mudguard
H	JPM lashing point
I	Sideboard
J	Right rear pillar
K	Rear door
L	Left rear pillar
M	Locking grip
N	Subframe

Options

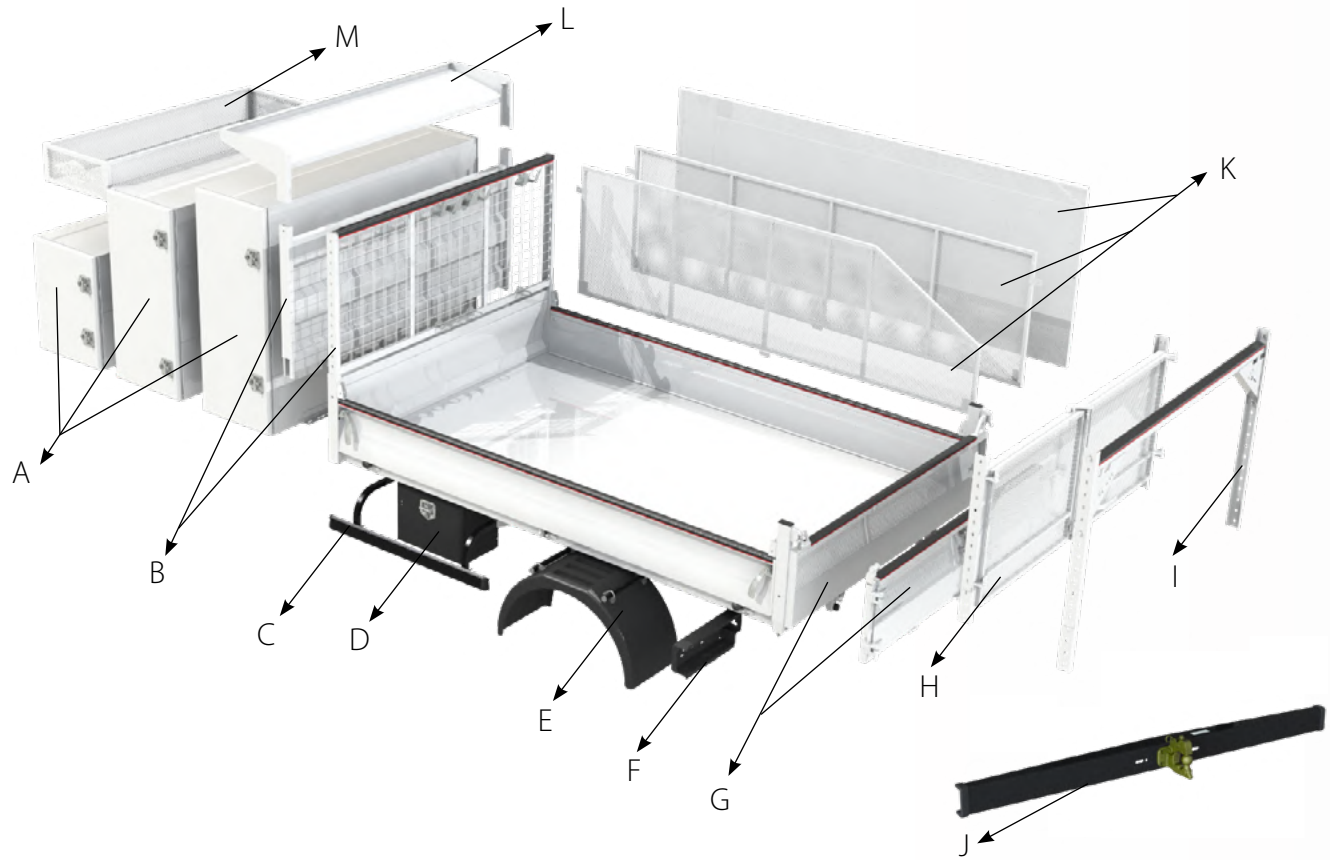

ITEM	DESIGNATION
A	Toolbox behind driver's cab
B	Gantry
C	Side underrun protection
D	Storage box under frame
E	Mudguard
F	Light protections
G	Rear door
H	Rear sideboard extension
I	Rear ladder holder
J	Towing device
K	Sideboard extension
L	Cab protection on gantry
M	Toolbasket

SIDE UNDERRUN PROTECTION	14
MUDGUARD	16
FIXING BRACKET	20
SPECIFIC PARTS	21
ELECTRO PUMP UNIT	24
CYLINDER	28
REMOTE CONTROL	31
GANTRY	32
REAR PILLARS	36
REAR DOOR	38
HANDLES	46
SIDEBOARD	47
REAR UNDERRUN PROTECTION WITH TOWING DEVICE	51

LIGHT BRACKETS	56
LIGHT PROTECTIONS	57
TOOLBOX BEHIND DRIVER'S CAB	58
TOOLBOX DOOR	60
OTHER TOOLBOXES BEHIND DRIVER'S CAB	62
STORAGE BOX UNDER FRAME	63
EXTENSIONS	65
TOOL HOLDER	71
REAR LADDER HOLDER	72
SIGNALISATION	73
LOAD NET	75
CONVERSION ACCESS	77
OTHER OPTIONS	78



Ref. : F001

Complete Kit underrun protection with medium connecting members for 3.5T (for subframe 1000 mm) - Length 2150 mm

Ref. : F000

Complete Kit underrun protection with short connecting members for 3.5T (for subframe 1320 mm) - Length 2150 mm

Ref. : F006

Complete Kit underrun protection with long connecting members for 3.5T (for subframes 700 / 740 / 850 mm) - Length 2150 mm



Ref. : F007

Complete Kit underrun protection for 7.5T vehicle
Cannot be sold separately for regulatory reasons

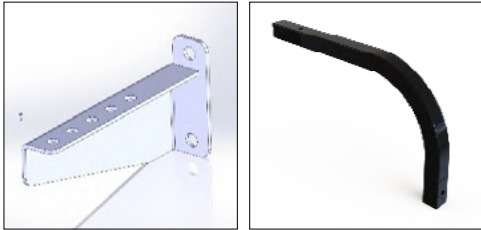

Ref. : R100

Bracket + long connecting member for 3.5T - for subframes 700 / 740 / 850 mm

Ref. : R102

Bracket + short connecting member for 3.5T - for subframe 1000 mm

Ref. : R101

Bracket + Connecting member for 7.5T vehicle - for subframe 1320 mm



Ref. : R110

Underrun protection profil Length 2150 mm + 2 endcaps

Ref. : R116

Set of caps (2 left caps + 2 right caps)





Sold per Unit



Ref. : F10E

Mudguard kit for twin wheel DRW 3.5T (450x440x890 mm) + Mudguard brackets length 448 mm + screw kit

Ref. : R202

Mudguard kit for twin wheel DRW 3.5T (450x440x890 mm)



Sold per Unit

Ref. : F10C

Mudguard kit for single wheel SRW 3.5T (260x440x890 mm) + Mudguard brackets length 448 mm + screw kit

Ref. : R203

Mudguard kit for single wheel SRW 3.5T (260x440x890 mm)



Ref. : R214

Kit 2 mudguards brackets length 448 mm





Sold per Unit

Ref. : F10F

Kit Mudguard twin wheel DRW 7.5T (510x580x mm) + white edging + mudguard bracket 548 mm + screw kit

Ref. : R204

Kit Mudguard twin wheel DRW 7.5T (510x580x mm)



Ref. : R215

Kit 2 mudguards brackets 548 mm



Length of mudguard brackets depends on vehicle type : please indicate serial number of tipper or type of vehicle.
To find your serial number, please search the label on driverside (front panel or subframe) as shown on page 3.



Ref. : R220

Kit Mudflaps single wheel SRW 260x300 mm Logo JPM + screw kit (set of 2)

Ref. : R221

Kit Mudflaps twin wheel DRW 400x300 mm Logo JPM + screw kit (set of 2)



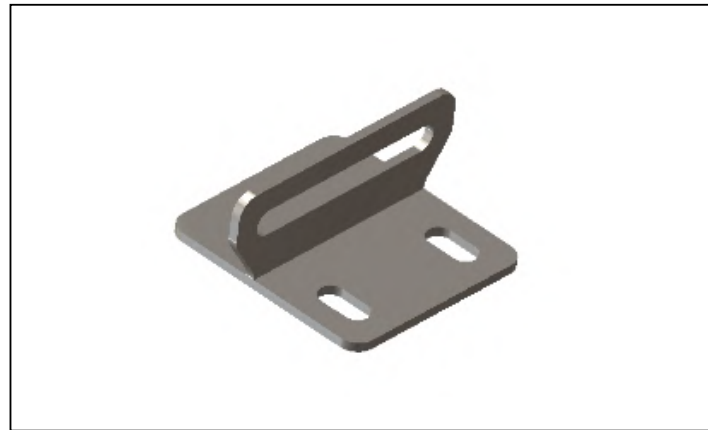

Overview - not exhaustive



Study according to vehicle serial number

To find your serial number, please search the label on driverside (front panel or subframe) like this :

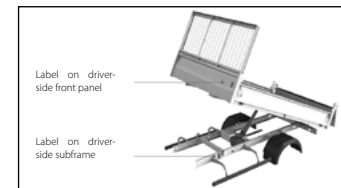

SPECIFIC PARTS

REAR TIPPER & 3-WAY-TIPPER



Ref. : R4A1

2 tipping shafts (only for rear tipper)

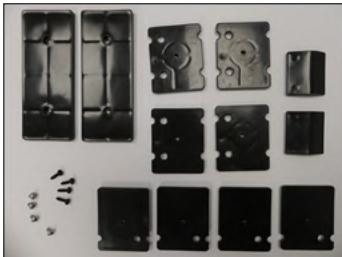

Ref. : RD03

Set of 2 tipper stops and buffers (only for rear tipper)

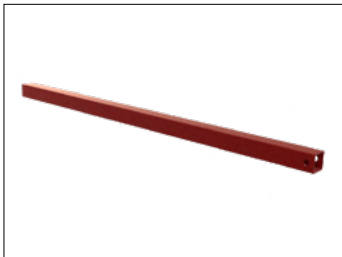

Ref. : RD07

Safety strut + plastic end cap



3 WAY TIPPER

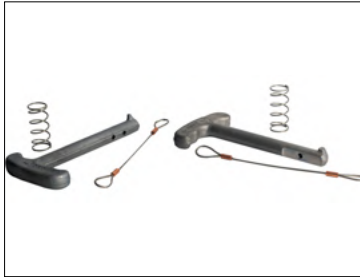

ORIGINAL



VULCAIN

Ref. : RD0J

Locking pin for ball diameter 60 for 3-way-tipper
(set of 2 pieces)



ORIGINAL



VULCAIN

Ref. : R4A4

Ball bearing (set of 4 pieces)

REMOVABLE TIPPER



Ref. : R4A3

2 Rear rolls in aluminium

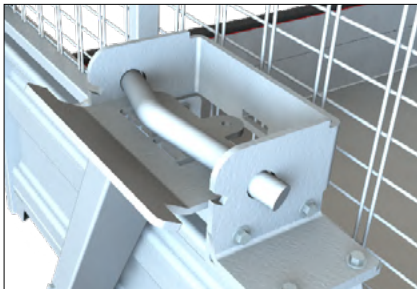

Ref. : RD0H

Anti-theft system only on removable tipper



REAR TIPPER



Ref. : R500

Power pack rear tipper 12v 180 bar

Ref. : R501

Power pack rear tipper 24v 180 bar

Ref. : R502

Power pack rear tipper 12v 180 bar
(range 75 - 7.5T vehicle)

3 WAY TIPPER



Ref. : R510

Power pack rear tipper 24v 320 bar

Ref. : R511

Power pack 3-way tipper 12v 320 bar

Ref. : R520

Power pack Pick up 12v 180 bar

Ref. : R530

Power pack with 2 cylinders for 7.5T vehicle
Tank 15l 180 bar



Ref. : R560
Switch relay 12v

Ref. : R561
Switch relay 24v



Ref. : R585
Fuse 250 Amp



Ref. : R586
Circuit breaker lateral tilting for 3-Way tipper





Ref. : R660
Flow restrictor



Ref. : R581
Circuit breaker

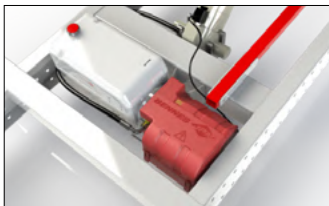

Ref. : R583

Plastic cover for power pack protection

Red cover : standard oil,

Green cover : biodegradable oil



Ref. : R570

Electric cable 2 m

Ref. : R571

Electric cable 5 m

25 mm² cross-section



Ref. : RD09

Buzzer for tipping process (supplied with pressure controller + wire)

Ref. : RD10

Pressure controller only



REAR TIPPER



Telescopic cylinder

Depending on tipper length

Ref. : R600

Telescopic cylinder 296

Ref. : R602

Telescopic cylinder 307

Ref. : R605

Telescopic cylinder 445

Ref. : R601

Telescopic cylinder 306

Ref. : R604

Telescopic cylinder 345



Cylinder is supplied alone – Solenoid valve has to be ordered separately

CYLINDER

3 WAY TIPPER



Ref. : R621

Tipping hoist with compass system 3.5T

Ref. : R622

Tipping hoist with compass system 5.5T



Ref. : R631

Solenoid Valve 12v Length 800 mm

Ref. : R632

Solenoid Valve 12v Length 3200 mm

Ref. : R633

Solenoid Valve 24v Length 800 mm



Cylinder is supplied alone – Solenoid valve has to be ordered separately



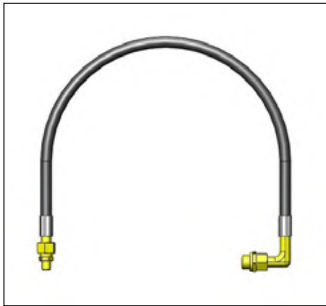

Ref. : R640

Flexible hose telescopic cylinder length 1200 mm

Ref. : R641

Flexible hose tipping hoist with compass system (set of 2 hoses)



Ref. : R550

Wired remote control 7m



Ref. : OH22

Wireless remote control

Complete set with transmitter and receiver



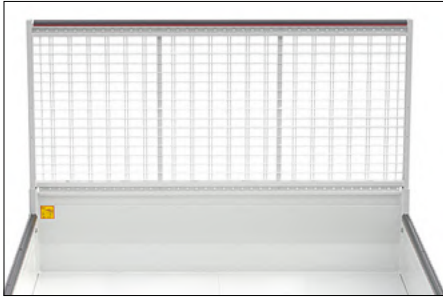

Ref. : R705

Standard gantry steel wire meshed
(without plastic protection - should be ordered separately)

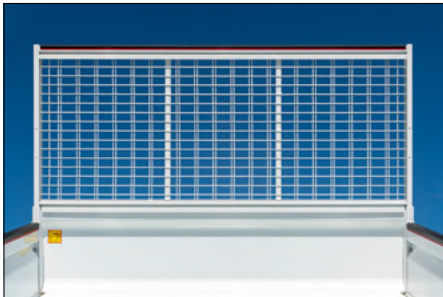

Ref. : R707

Standard gantry aluminium wire meshed
(without plastic protection - should be ordered separately)

GANTRY



Ref. : OD0D

Kit 2 lashing points for steel gantry
TUV-certified DaN

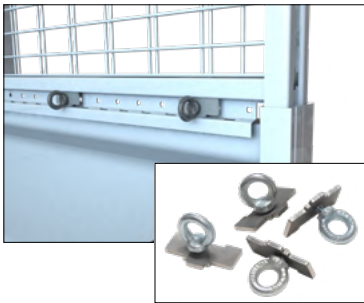

Ref. : OD01

Set of 4 lashing rings

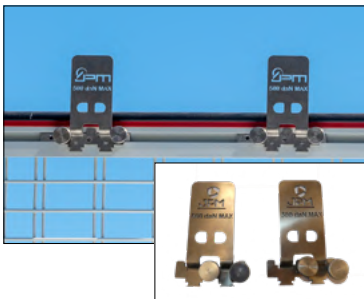

Ref. : OD0N

Set of 2 load stops 400 DaN





Ref. : OD0Q

Reinforced polypropylene filling for gantry (2080 x 900 mm)



Ref. : OD0J

Reinforcement double bar with protection



Ref. : OD04

Plastic protection for steel gantry

Plastic protection for alu gantry

Length 2000 mm for tipper width up to 2080 mm

Length 2500 mm for tipper width up to 2280 mm



Ref. : O791

Set of 4 mounting removable brackets

(From 2022)



REAR TIPPER - 3 WAY TIPPER



Ref. : RB20

Steel rear pillar left (complete set)

Ref. : RB21

Steel rear pillar right (complete set)



Ref. : RB92

Set of 2 closures for rear pillars



Ref. : RB93

Set of 2 plugs for rear pillars

DROPSIDE



Full Alu Dropside

Ref. : RB70

Alu rear pillar left

Ref. : RB71

Alu rear pillar right



Full Steel Dropside

Ref. : RB40

Steel rear pillar left

Ref. : RB41

Steel rear pillar right



Aluminium dropside wood platform

Ref. : RBA0

Alu rear pillar left

Ref. : RBA1

Alu rear pillar right



REAR DOOR

STANDARD rear door, height 450 mm with automatic opening

REAR TIPPER - 3 WAY TIPPER



Ref. : RC20

Vulcain steel rear door, automatic opening, height 450 mm
(without plastic protection)
For Vulcain steel range



Ref. : RC50

Vulcain aluminium rear door, automatic opening, height 450 mm
For Vulcain aluminium range



Ref. : RC54

Original aluminium rear door, automatic opening, height 450 mm
(without plastic protection)



Ref. : RC82

Set of 2 rubber buffers stops



Ref. : RC84

Set of 2 rubber buffers stops for Easydoor Original rear door (RC56)



REAR DOOR

UNIVERSAL rear door, height 450 mm: double-winged door with automatic opening



Ref. : RC22

UNIVERSAL rear door Steel - Height 450 mm
For Vulcain steel range

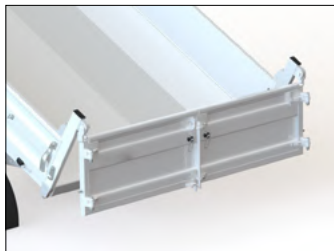

Ref. : RC53

UNIVERSAL rear door Aluminium - Height 450 mm
For Vulcain aluminium range



Ref. : RC55

UNIVERSAL rear door Aluminium Original - Height 450 mm
Supplied with 1+1 locking clamps left and right (ref. RC87)
For Original aluminium range



Ref. : RC32

Set of screws for universal door

Compatible with the steel universal door (RC22 & RC53)
and with the old model aluminium universal door





Ref. : RC51

EASYDOOR Rear Door Vulcain- Height 400 mm, automatic opening + tilting with door opened downwards
Only available in aluminium



Ref. : RC56

EASYDOOR Rear Door Original - Height 450 mm, automatic opening + tilting with door opened downwards
Only available in aluminium
Supplied with 1+1 locking clamps left and right (ref. RC87)

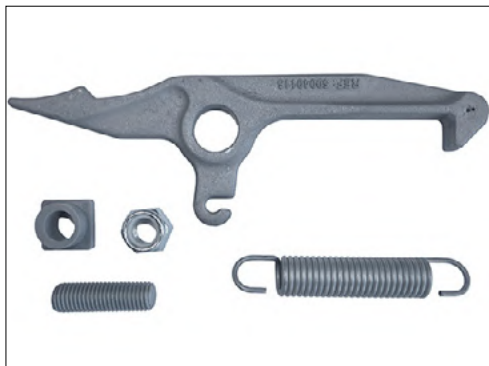

Ref. : RC86

Detaching hook + Galvanised spring

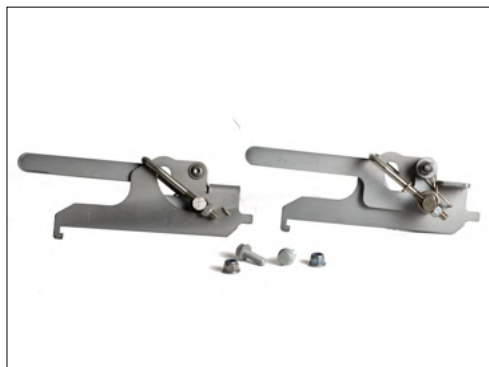

Ref. : RC87

Set of 2 locking clamps - right / left frame
For Easydoor rear door and Original universal rear door
For Original aluminium range



DROPSIDE



Ref. : RC21

Rear Door full steel dropside - Complete set - Height 350 mm
For Vulcain steel range

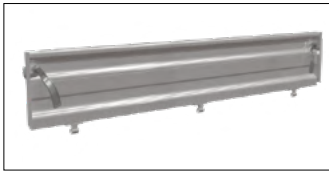

Ref. : RC52

Rear Door full alu dropside - Complete set - Height 350 mm
For Vulcain aluminium range



Ref. : RC70

Rear door Alu dropside wood platform - Complete set
Anodised alu - Height 400 mm
Not compatible with plastic protections



Ref. : RA48

Set of 1 + 1 side panel locks without safety latch - Left + right
Height 400 mm
For rear door

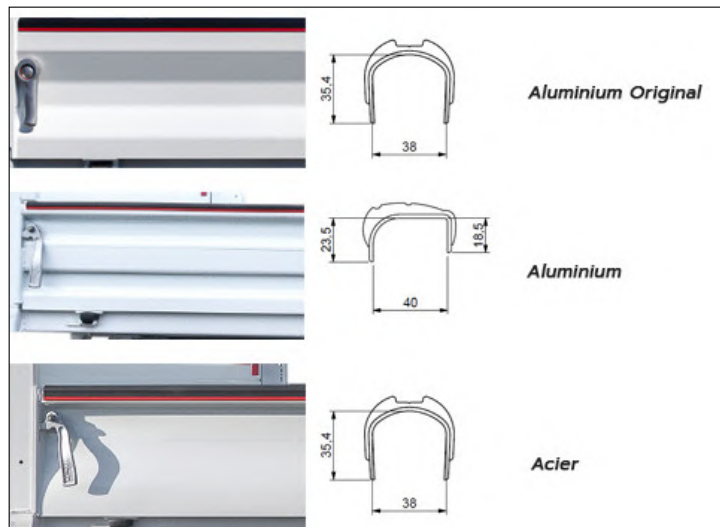

Ref. : O600

Plastic protection for rear door
For Vulcain steel range or aluminium Original range
(RC20 - RC22 - RC54 - RC55 - RC56)

Ref. : O604

Plastic protection for rear door
For Vulcain aluminium range (RC50 - RC51 - RC53)





Ref. : RA50

Set of 1 + 1 handgrips for sideboard & EASYDOOR rear door right and left
For Vulcain range



Ref. : RA55

Set of 1+1 sideboard handles Original right and left
For Original range

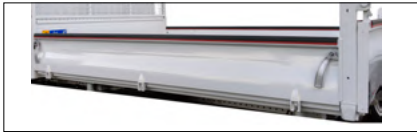

Ref. : RA00

Steel Sideboard - Height 350 mm

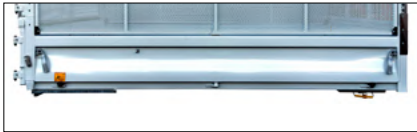

Ref. : RA03

Steel Sideboard - Height 400 mm - 75 range

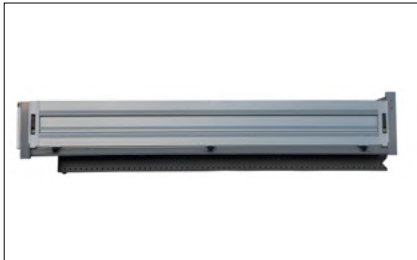

Ref. : RA42

Alu sideboard for Dropside wood platform Height 400 mm
Anodised alu



Ref. : RA49

Set of 1 + 1 side panel locks with safety latch - Left + right
Height 400 mm
For sideboard





Ref. : RA40

Vulcain range aluminium sideboard for rear tipper, 3-way tipper, dropside
Height 350 mm

Ref. : RA41

Vulcain range aluminium sideboard for rear tipper, 3-way tipper, dropside
Height 400 mm



Ref. : RA43

JPM Original range aluminium sideboard, Enterprise 3-way tipper
(without protection)
Height 400 mm



Delivered as a complete set, ready to install

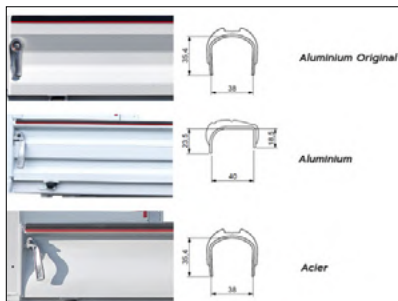

Ref. : OF00

Plastic protection for steel sideboard (2 pieces)

For Vulcain steel range and Aluminium Original range (35,4 x 38 mm) (RA00/RA43)

Ref. : OF01

Plastic protection for alu sideboards (2 pieces) except dropside Wood platform

For Vulcain aluminium range (RA40)

(23,5 x 40 x 18,5 mm)



Ref. : RA53

Set of 6 sideboard stops

For Vulcain sideboards



Ref. : RA56

Set of 6 sideboard stops

For Original Aluminium range





Ref. : OF0E

Lift assist spring kit for sideboard

Consult us (depending on material or width of sideboard)



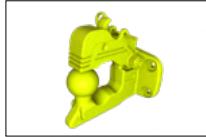

Ref. : OB00

Complete kit TRIVA ENTREPRISE (without cover plate)

Triva Entreprise = ICC bar + Head stock + 1 coupling height

Head stock approved up to GVWR ≤ 11 T (depending on the vehicle)

ICC bar approved up to GCWR ≤ 7.5 T (depending on the vehicle)

One coupling height : mixed hook

Coupling not included (cf. OB33) - depending on subframes - contact us



Ref. : OB01

Complete kit TRIVA TP

Triva TP = Rear ICC bar + Head stock + 2 coupling heights

Triva approved in compliance with UN Regulations 55R01 and 58R03

Head stock approved up to GVWR ≤ 9 T

ICC bar approved up to GCWR ≤ 5.5 T

2 towing heights:

- Ball hook at regulation height
- Clevis hitch adhering to the regulatory clearance of the ball and ideally positioned for drawbar eye

For vehicles registered before July 2024





Ref. : OB30

JPM towing pin (manual)

Caution : not allowed by road traffic regulations of some countries

Trailer capacity $\leq 3T5$ + depending on vehicle



Ref. : OB31

JPM towing ball diameter 50



Ref. : OB33

Mixed apple tree hook

Caution : not allowed by road traffic regulations of some countries

Trailer capacity $\leq 3T5$ + depending on vehicle



Ref. : OB35

MINITRACT semi-automatic towing pin

Trailer capacity $\leq 3T5$ + depending on vehicle



Ref. : OB36

Plug + pin + cable

For OB30



Ref. : RE01

Cover plate

Depending on subframes - contact us





Ref. : OB10

Towing device adapter 13 to 7 pin



Ref. : OB12

24V / 12V voltage divider



Ref. : OB20

For vehicle predisposed



Ref. : OB2X

Towing device plug predisposed - specific to each type of vehicle

For vehicle no predisposed



LIGHT BRACKETS



Ref. : OC00

TRIVA ENTREPRISE Light brackets right/left (set of 2 pieces)



Ref. : OC01

TRIVA TP / DUAL TRIVA Light brackets (set of 2 pieces)

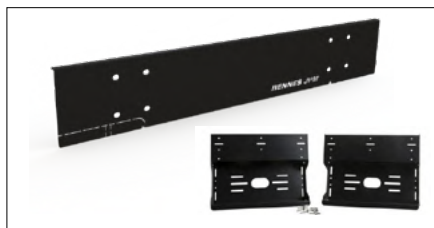

Ref. : OC02

Light support on cover plate (1 unit)
Depending on subframes - contact us



Light brackets & light protections :
please indicate brand, model, single or twin rear wheels



Ref. : OC10

Homologated light protections compatible with :

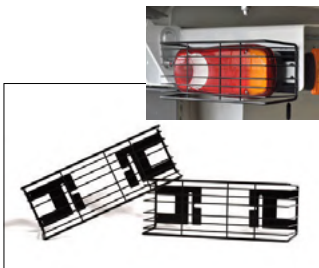

Ref. : RC1B

Headlamp grills for VIGNAL
LC5 and fabrilcar E9-1211
lamps

- Renault Master, Range D, Maxity
- Nissan NT400, NT500, NV400
- Fiat Ducato,
- Peugeot Boxer,
- Citroën Jumper
- Fuso Canter
- Opel Movano
- Iveco Daily (from 2022)

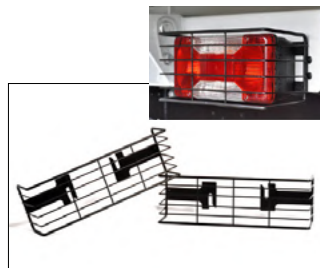

Ref. : RC1D

Headlamp grills for FARBA
14 309F lights

- Ford Transit

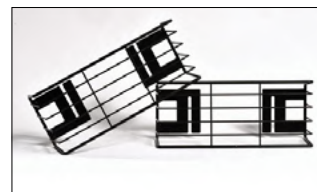

Ref. : RC1A

Headlamp grills for COBO
E9-2060 lights

- Iveco Daily (before 2022)

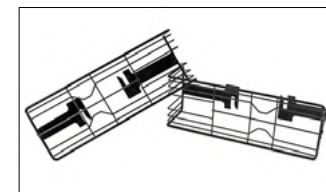

Ref. : RC1C

Headlamp grills for VIGNAL
LC8 LC8KD LC11 lamps

- Mercedes Spriter,
- Volkswagen Crafter 35/50,
- Man TGE



Ref. : RC1F

Headlamp grills for QOITO lights

- Isuzu



TOOLBOX BEHIND DRIVER'S CAB



- Steel or aluminium toolbox
- Steel 2 mm or aluminium 3 mm
 - with rubber seal
 - Integrated locks
 - Gas pressure spring
 - Fixation for shelves
 - Supplied with subframe extension in aluminium or steel depending on toolbox model
 - Can be supplied with steel fixing feet 400x600 mm (2 units)

Dimensions (mm)	Ref. : Steel	Ref. : Aluminium
600x800x1700	O10B	/
600x800x1800	O100	O110
600x800x2000	O101	O111
600x1150x2000	O102	O112
600x1300x1700	O10C	/
600x1300x1800	O103	O113
600x1300x2000	O104	O114
600x1500x2000	O105	O115
800x800x1800	O106	O116
800x800x2000	O107	O117
800x1300x1800	O108	O118
800x1300x2000	O109	O119
800x1500x2000	O10A	O11A



Ref. : O123

Wood shelf 12 mm thick

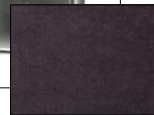

Ref. : O124

Non-slip perforated mat for toolbox 600 mm



Toolbasket perforated sheet on toolbox
Not fitted with lashing points
(Raw - Unassembled kit)

Ref. : RF60

600 x 250 x 1800 mm
Width/Height/Depth

Ref. : RF61

600 x 250 x 2000 mm
Width/Height/Depth



Complete door with lock + compass + hinges



Dimensions Right door

Dimensions (mm)	Ref. : Steel	Ref. : Aluminium
600x800	RF00	RF20
600x1300	RF01	RF21
600x1500	RF02	RF22
800x800	RF03	RF23
800x1300	RF04	RF24
800x1500	RF05	RF25
600x1150	RF06	RF26

Dimensions Left door

Dimensions (mm)	Ref. : Steel	Ref. : Aluminium
600x800	RF10	RF30
600x1300	RF11	RF31
600x1500	RF12	RF32
800x800	RF13	RF33
800x1300	RF14	RF34
800x1500	RF15	RF35
600x1150	RF06	RF26



Rubber seal (set of 2 pieces - for one toolbox)

Ref. : RF42

Height 1500 mm

Ref. : RF41

Height 1300 mm

Ref. : RF40

Height 800 mm



Ref. : RF43

Gas pressure spring



Ref. : RF55

Set of 6 locker hinge pins



Ref. : RF44

Toolbox lock inox with seal and 2 keys included
(1 or 4 pieces : please specify)



OTHER TOOLBOXES BEHIND DRIVER'S CAB



Ref. : O300

Alu toolbox on platform

Only available in white or RAL 7004

Dimensions : 600 x 500/600 x 1980 mm

Can be supplied with steel fixing feet 400x600 mm (2 units)





Stainless steel storage box - EC homologated
supplied with fixing brackets

Ref. : O520

500x400x370 mm
Width/Height/Depth



Ref. : O521

700x400x370 mm
Width/Height/Depth



STORAGE BOX UNDER FRAME



Plastic storage box under frame - EC homologated
supplied with fixing brackets

Ref. : O504

W500 x H400 x D370 mm
Width/Height/Depth

Ref. : O505

W500 x H350 x D300 mm
Width/Height/Depth



Ref. : O506

Strap storage box W500 x H350 x D300 mm
Width/Height/Depth

Polyurethane box equipped with wooden storage box + 6 sets of straps
Supplied with fixing brackets



Please indicate Serial No. of tipper/dropside or vehicle type.
Be careful ! It is the responsibility of the installer to ensure
that enough space under frame is available to install a storage box.

SIDEBOARD EXTENSIONS



Ref. : O730

Perforated alu height 900 mm

Ref. : O731

Perforated alu height 450 mm

Ref. : O73Z

Perforated alu non standard height



FULL EXTENSIONS



Ref. : O760

Full alu height 900 mm

Ref. : O761

Full alu height 450 mm

Ref. : O76Z

Full alu height non standard height



Straight sideboard extensions
Max. Length 4000 mm Height 900 and 450 mm: please specify



Ref. : O740

Perforated alu height 900 mm



Ref. : O770

Full Alu height 900 mm



Sideboard extensions – canted sides - Max. Length 4000 mm Height 900 mm



FOLDING EXTENSIONS



Ref. : O750

Perforated Alu Height 900 mm
300 mm fixed + 600 mm mobile



Ref. : O780

Full alu height 900 mm
300 mm fixed + 600 mm mobile



Sideboard extensions foldable -
Max. length 4000 mm Height 900 mm - Foldable at 300 mm

REAR DOOR EXTENSIONS - 2 PANELS

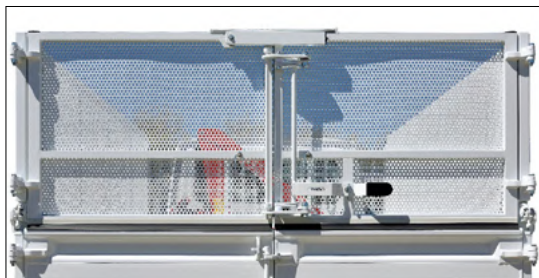

Ref. : O830

Perforated Alu Height 900 mm

Ref. : O860

Perforated Alu Height 600 mm



Ref. : O850

Full Alu Height 900 mm

Ref. : O870

Full Alu Height 600 mm



Double-winged rear door extension height 900 or 600 mm
Only with UNIVERSAL & EASYDOOR rear door : please specify



REAR DOOR EXTENSIONS - HIGH TILTING EXTENSIONS

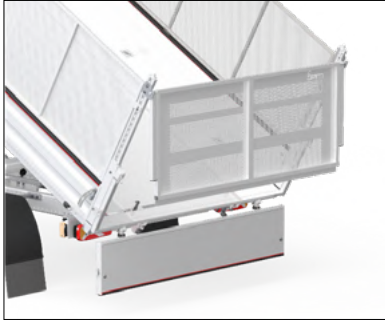

Ref. : O820

Alu perforated sheet height 900 mm

Ref. : O821

Alu perforated sheet height 600 mm



Ref. : O840

Full Alu height 900 mm

Ref. : O880

Full Alu height 600 mm



Rear door extension oscillating at the top for EASYDOOR only



Ref. : OD03

Tool holder 3 tools aluminum 3 mm thickness

Available on steel wire meshed, perforated, full alu and alu plank gantry

Compatible with R705 and R707



Ref. : OD0M

Tool holder 1 tool aluminum 3 mm thickness

Available on steel wire meshed, perforated, full alu and alu plank gantry

Compatible with R705 and R707



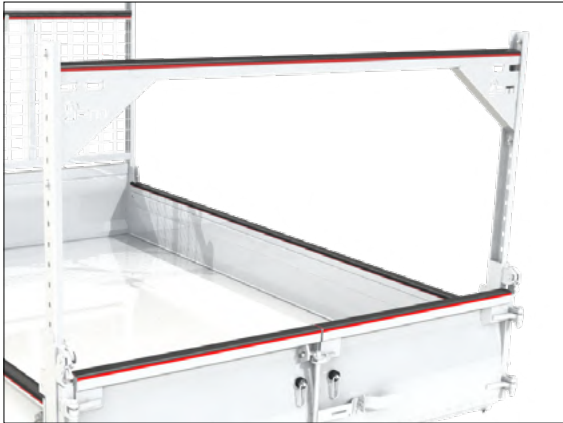

Rear ladder holder removable steel

Ref. : OE0Z

For all dimensions

(plastic protection not included - should be ordered separately)

Height adjustable



2 Revolving beacon lights + fixing bar + warning triangle

Ref. : OC43

Automatic electric lifting
Supplied with wired remote control
To stick



Ref. : OC40

Flashing beacon only
To stick



Ref. : OH02

Cone holder (equipped with 6 cones)
Not compatible with subframe 1320 mm





Ref. : OC20

Side marker lamps predisposed
(mandatory for vehicles Length > 6000 mm, 2 pieces)



Ref. : OC22

Overall size lamps 2 functions LED universal without plug
(mandatory for vehicles width > 2100 mm)



Compatible with tipper length 2500 à 4500 width 2000 mm (not 1880 mm)

Ref. : OA50

Load net body length 2500 to 2900 mm - width 1880/2080 mm + hooks

Ref. : OA51

Load net body length 3050 to 3400 mm - width 1880/2080 mm + hooks

Ref. : OA52

Load net body length 3500 to 3800 mm - width 1880/2080 mm + hooks

Ref. : OA53

Load net body length 3900 to 4500 mm - width 1880/2080 mm + hooks



Ref. : OA10

Fastening eyes/hooks





Ref. : OA22

Tipper protective roof

Compatible with tippers 2900, 3050, 3200, 3300, 3500 mm
and width 2000 mm



Ref. : O900

Folding footstep
Access with sideboard open



Ref. : O901

Handgrip



Ref. : O903

3-step ladder (not for 3-way-tipper and tipper <2000 mm)
Non-slip steps
To be attached on the left or right under the rear universal door of the tipper



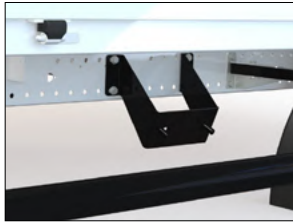

Ref. : OH20

Emergency wheel bracket screwable IVECO



Ref. : RD0K

Set of 2 lashing points

To be fitted on the outer frames of aluminium Original tippers and aluminium dropside, wood platform



Ref. : RD0G

Lashing points (2 pieces) for any type of tipper & dropside except dropside with wood platform

Pictures and photos non-contractual - November 2024





**ZA Le Relais de Merlin
12800 Naucelle - FRANCE
Tel +33 (0)5 65 69 24 70
Fax +33 (0)5 65 69 23 77**

www.jpm-group.com